

- **Style: CTE (Centralized Thermal Efficiency) Form Factor Design**
- **Size: Mid Tower supports up to E-ATX MB**
- **Material: Steel & Tempered Glass**

Main Features

- **Connection** : Front I/O ports with 2 x USB 3.0 & 1 x USB 3.2 (Gen 2) Type C
- **Ventilation** : 3 preinstalled 140mm CT140 fan
- **Supports** : Supports AIO/DIY cooling solutions



| Spec | Model | CTE C700 Air | CTE C700 Air Snow |
|------|---------------------------|-------------------------------------------------------------------------------------------------------------------------------------------------------------------------------------------------------------------------------------------------------------------------------------------------------------------------------------------------------------------------|-----------------------------------------------------------------------------------------------------------------------------------------------------------------------------------------------------------------------------------------------------------------------------------|
| | P/N | CA-1X7-00F1WN-00 | CA-1X7-00F6WN-00 |
| | Case Type | Mid Tower | |
| | Chassis Dimension (H*W*D) | 566.5 x 327.6 x 505.5 mm (22.3 x 12.9 x 19.9 inch) | |
| | Net Weight | 15.6 kg / 34.39 lbs. | 15.8 kg / 34.83 lbs. |
| | Panel | 4mm Tempered Glass x 1 | |
| | Color | Black | White |
| | Material | SPCC / ABS | |
| | Cooling System | Front(intake): 140 x 140 x 25 mm CT140 fan (1500rpm, 30.5 dBA) x 1 Top(exhaust): 140 x 140 x 25 mm CT140 fan (1500rpm, 30.5 dBA) x 1 Rear(intake): 140 x 140 x 25 mm CT140 fan (1500rpm, 30.5 dBA) x 1 | Front(intake): 140 x 140 x 25 mm CT140 white fan (1500rpm, 30.5 dBA) x 1 Top(exhaust): 140 x 140 x 25 mm CT140 white fan (1500rpm, 30.5 dBA) x 1 Rear(intake): 140 x 140 x 25 mm CT140 white fan (1500rpm, 30.5 dBA) x 1 |
| | Drive Bays | 7 x 3.5" or 6 x 2.5" | |
| | Expansion Slots | 7 | |
| | Motherboards | 6.7" x 6.7" (Mini ITX), 9.6" x 9.6" (Micro ATX), 12" x 9.6" (ATX), 12" x 13" (E-ATX) | |
| | I/O Port | USB 3.2 (Gen 2) Type-C x 1, USB 3.0 x 2, HD Audio x 1 | |
| | PSU | Standard PS2 PSU (optional) | |
| | Fan Support | Front: 3 x 120mm, 2 x 120mm, 1 x 120mm 3 x 140mm, 2 x 140mm, 1 x 140mm 2 x 200mm, 1 x 200mm Top: 2 x 120mm, 1 x 120mm 2 x 140mm, 1 x 140mm Right: 1 x 120mm, 1 x 140mm Rear: 3 x 120mm, 2 x 120mm, 1 x 120mm 3 x 140mm, 2 x 140mm, 1 x 140mm Bottom: 3 x 120mm, 2 x 120mm, 1 x 120mm 2 x 140mm, 1 x 140mm | |
| | Radiator Support | Front: 1 x 360mm, 1 x 240mm, 1 x 120mm 1 x 420mm(AIO only), 1 x 280mm, 1 x 140mm Rear: 1 x 360mm, 1 x 240mm, 1 x 120mm 1 x 420mm(AIO only), 1 x 280mm, 1 x 140mm Bottom: 1 x 360mm, 1 x 240mm, 1 x 120mm 1 x 280mm, 1 x 140mm | |
| | Clearance | CPU cooler max height: 190mm VGA max length: 327mm (With radiator) 410mm (Without radiator) PSU max length: 220mm | |

Packaging

| Package Information | CTE C700 Air | CTE C700 Air Snow |
|-------------------------|-------------------------------------------------|----------------------|
| EAN Code | 4713227535526 | 4713227537179 |
| UPC Code | 841163085530 | 841163087183 |
| N.W | 15.6 kg / 34.39 lbs. | 15.8 kg / 34.83 lbs. |
| G.W | 18.5 kg / 40.79 lbs. | 18.8 kg / 41.45 lbs. |
| Carton Size (L x W x H) | 604 x 429 x 676 mm / 23.78 x 16.89 x 26.61 inch | |
| Cuft | 6.18 | |
| Container | w/o pallet | |
| 20' | 152 pcs | |
| 40' | 320 pcs | |
| 40' HQ | 377 pcs | |



Appearance – Black version



Angle view



Left Side view



Front view



Right Side view

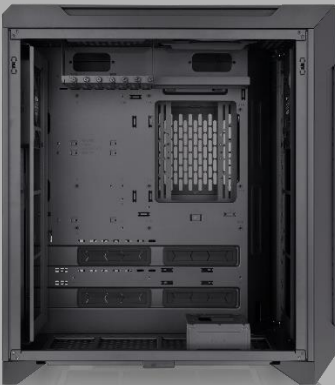

Internal Structure



Rear view



Top view

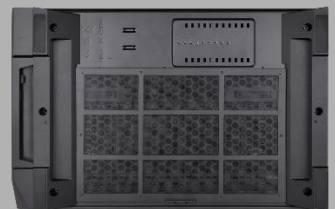

Bottom view

Appearance – Snow version



Angle view



Left Side view

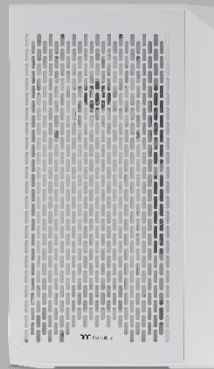

Front view



Right Side view



Internal Structure



Rear view



Top view

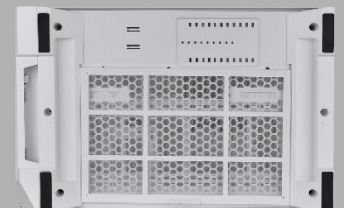

Bottom view

Clearance



Maximum supports up to 140mm fan x 11

Maximum radiator supports up to 420mm at front



Maximum 120/140mm top fan x 2

Structure (External)



USB 3.2 (Gen 2) Type-C x 1

USB 3.0 x 2

HD Audio



4mm Tempered Glass x1

Structure (Internal)



Front filter



Top filter



Rear filter



Bottom filter

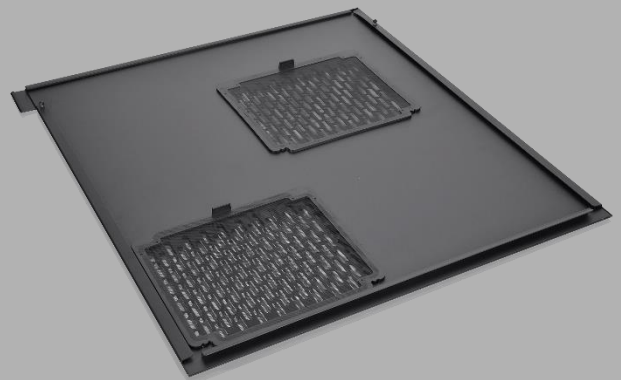

Right side filter

Structure (Internal)

It can support up to 2.5" SSD x 6



Place A

or



Place B



It can support up to 3.5" HDD x 7

Structure (Internal)



Pump bracket is compatible with Pacific PR12-D5 Plus



120mm Fan x 3
at the bottom



140mm Fan x 2
at the bottom

Structure (Internal)



Preinstalled 140mm
CT140 fan at the
front/top/rear



120/140mm Right fan x1 with HDD bracket

Structure (Internal)



Rotatable PCI-E Design



Exploded View

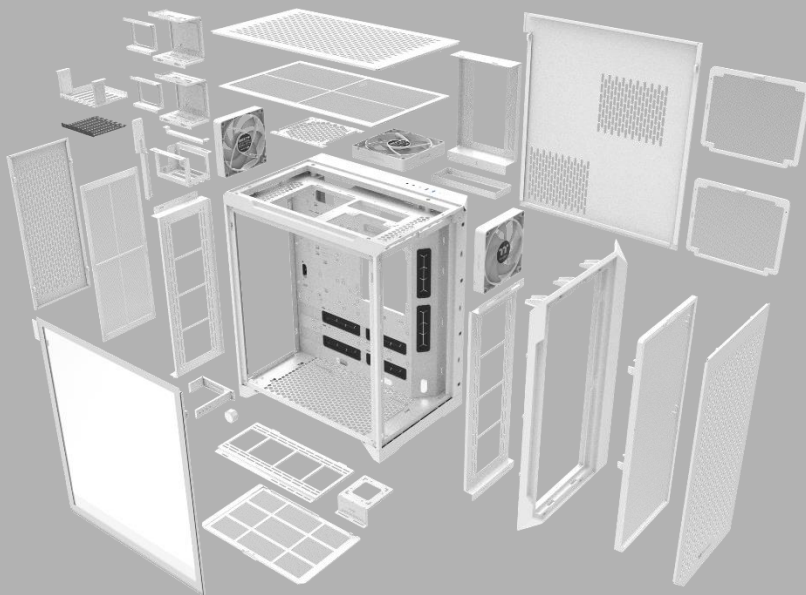
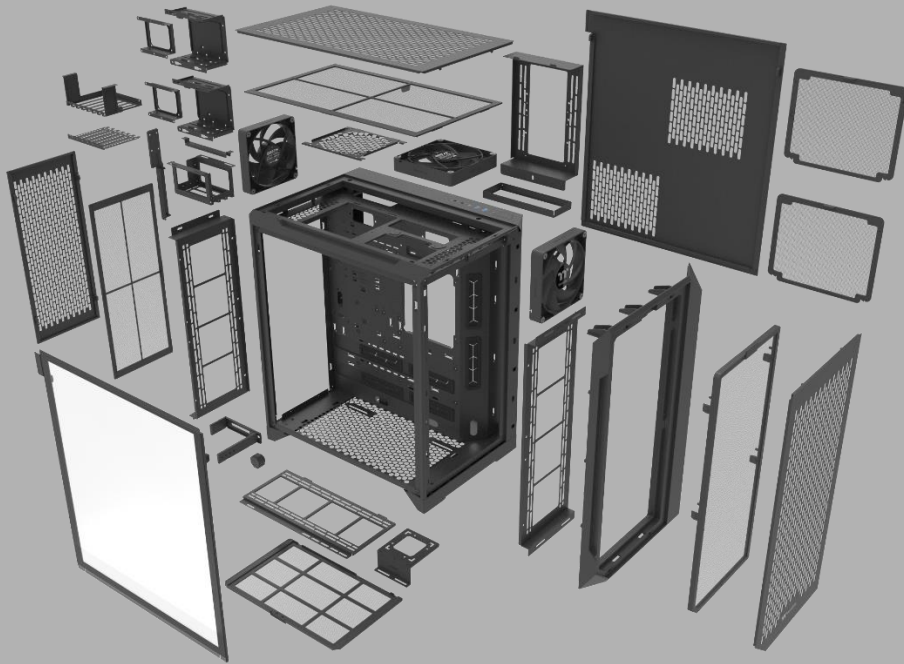

Pre-installed CT Fans



Pre-installed three hydraulic bearing **CT140** fans which can effectively lower the operation noise and enhance the thermal efficiency.



Black Version



Snow Version

SPEC for Case **CT140** fans

-Fan Speed: 500~1500 RPM

-Max. Fan Airflow: 77.37 CFM

- Max. Fan Air Pressure: 2.3 mm-H2O

- Fan Noise Level: 30.5 dBA

-Fan Bearing: Hydraulic bearing

Compatibility List

| Fan Compatibility List | | | |
|------------------------|-------|-------|-------|
| | 120mm | 140mm | 200mm |
| Front | 3 | 3 | 2 |
| Top | 2 | 2 | - |
| Right | 1 | 1 | - |
| Rear | 3 | 3 | - |
| Bottom | 3 | 2 | - |

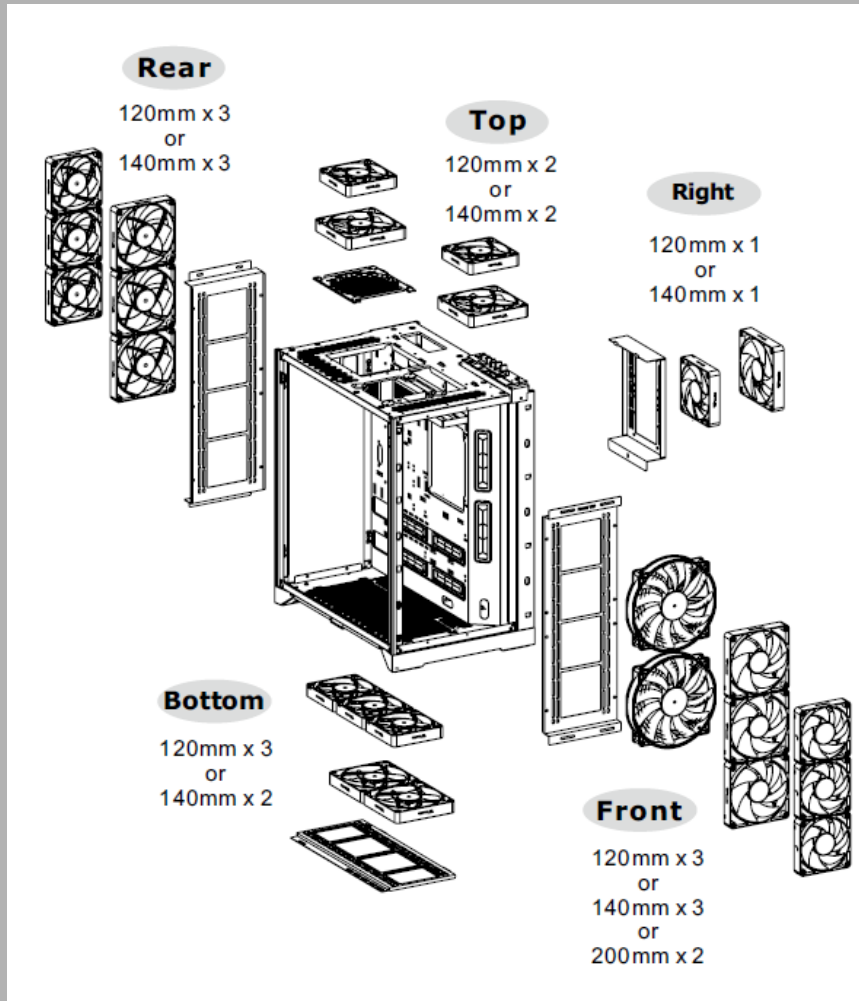

All-in-One Compatibility

| All-in-One Compatibility List | | | | | | |
|-------------------------------|-------|-------|-------|-------|-------|-------|
| | 120mm | 240mm | 360mm | 140mm | 280mm | 420mm |
| Front | ● | ● | ● | ● | ● | ● |
| Right | - | - | - | - | - | - |
| Rear | ● | ● | ● | ● | ● | ● |
| Bottom | - | - | - | - | - | - |

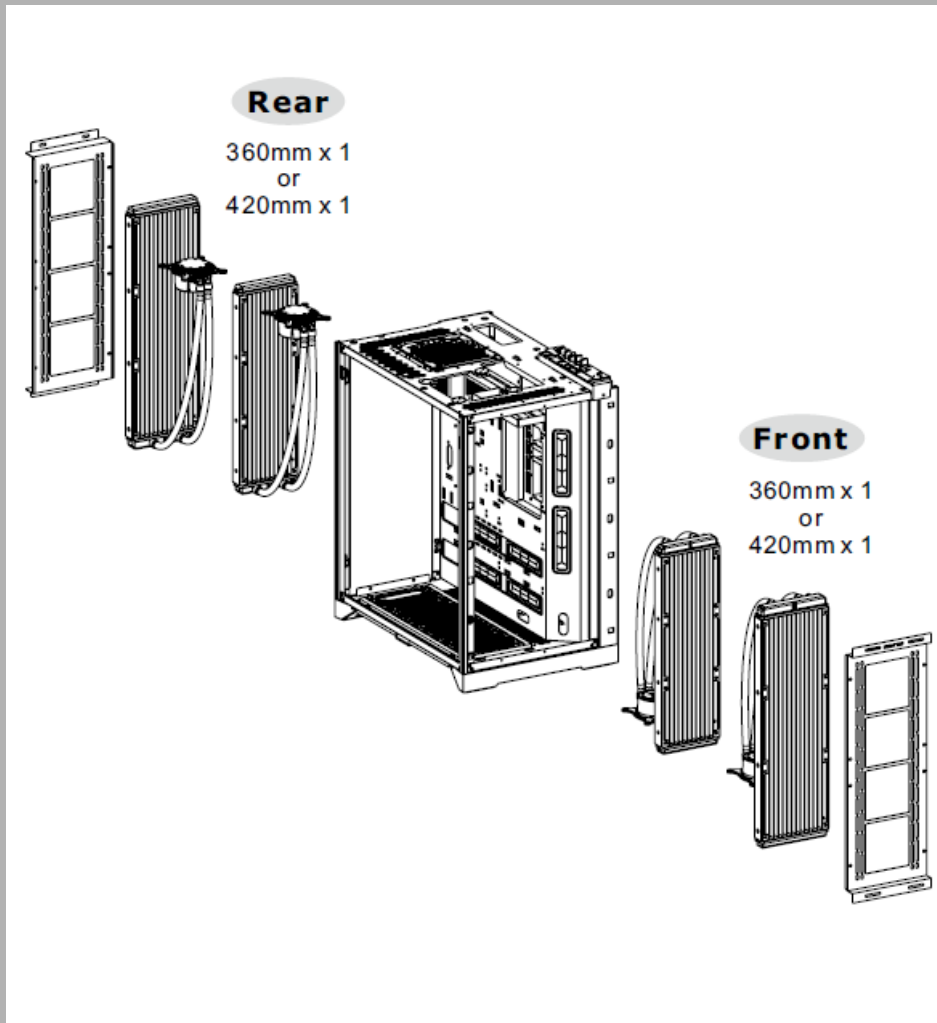

DIY Liquid Cooling Compatibility

| DIY Liquid Cooling Compatibility List | | | | | | |
|---------------------------------------|-------|-------|-------|-------|-------|-------|
| | 120mm | 240mm | 360mm | 140mm | 280mm | 420mm |
| Front | ● | ● | ● | ● | ● | - |
| Top | - | - | - | - | - | - |
| Rear | ● | ● | ● | ● | ● | - |
| Bottom | ● | ● | ● | ● | ● | - |

