

STORM T3

MANUAL

BELIEVE IT

www.Antec.com

All rights reserved. Specifications are subject to change without prior notice. Actual products and accessories may differ from illustrations. Omissions and printing errors excepted. Content of delivery might differ in different countries or areas. Some trademarks may be claimed as the property of others.

V2.2

©1986 – 2022 Antec, Inc. All rights reserved.

1 CONTENTS

120MM FAN

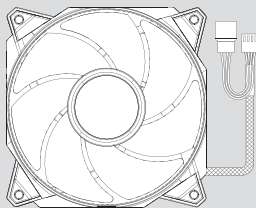

140MM FAN

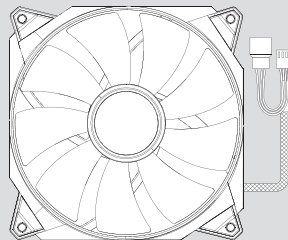

4-PIN PWM EXTENSION CABLE

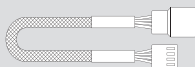

SCREW



2 FAN INTRODUCTION

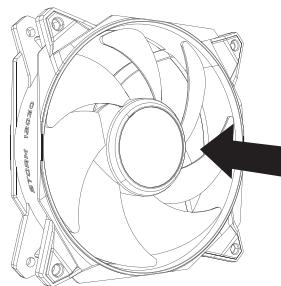

AIR - IN

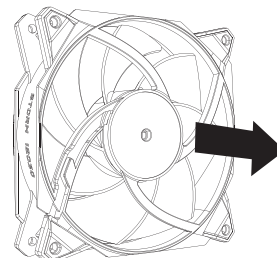

AIR - OUT

3 FAN INSTALLATION

FRONT

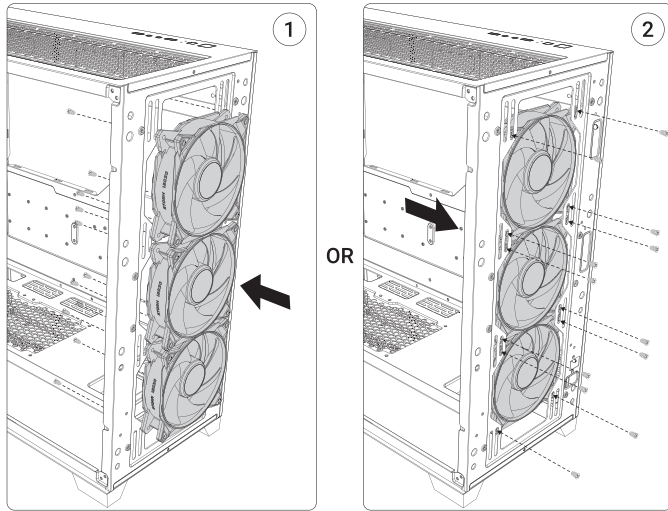

TOP

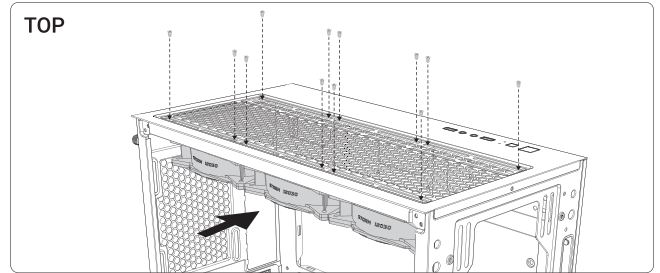

REAR

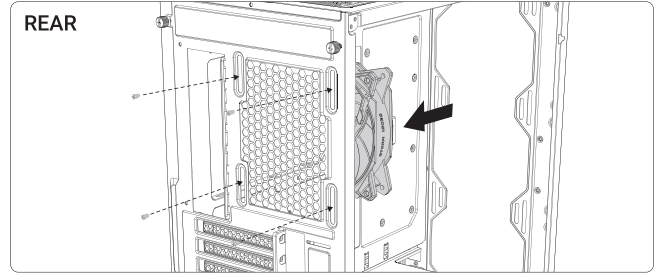

4 FAN CONNECTION

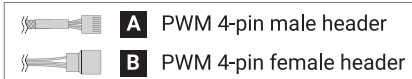

OPTION A :

- Connect the 4-pin connector with the 4-pin PWM extension cable, connect the 4-pin connector to the motherboard.

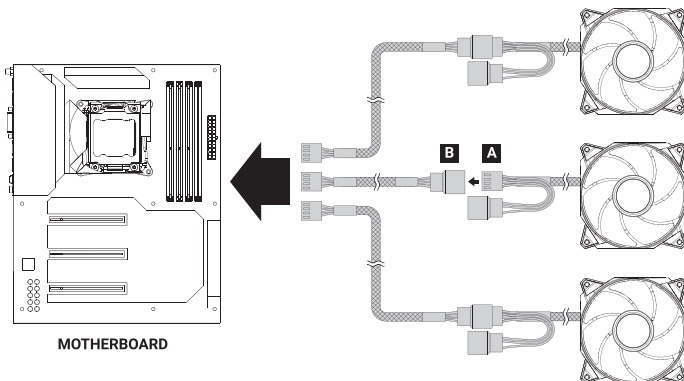

OPTION B :

- Connect the 4-pin connector to the 4-pin Daisy-chain to make fans work in sync.
- Connect the 4-pin connector with the 4-pin PWM extension cable, and connect the 4-pin connector to the motherboard.

